

Canasto Para Residuos

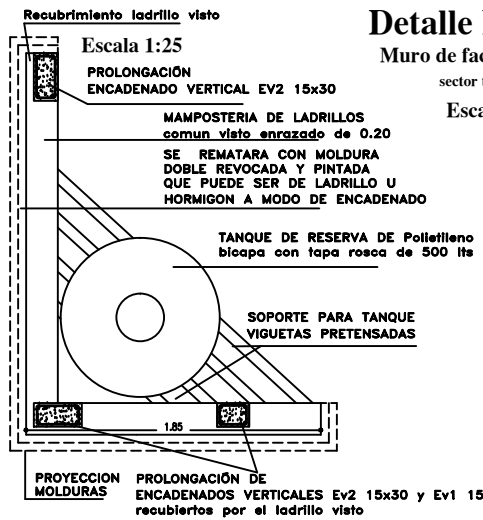

Base para tanque de reserva

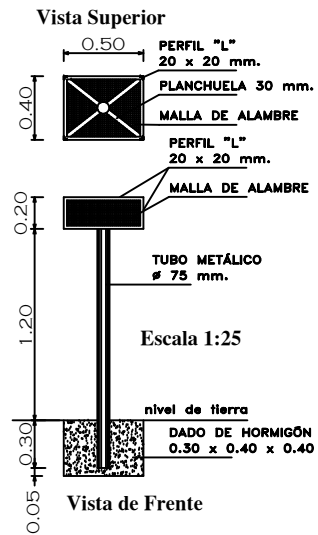
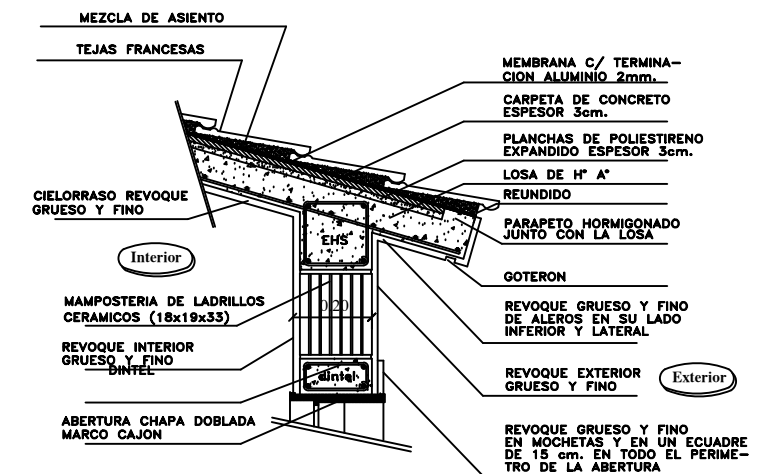

Detalle Constructivo Escala 1:10

Mampostería ladrillon (18x5x28.5) a la vista junta al ras.

Detalle Moldura

Muro de fachada frontal sector techo plano Escala 1:10

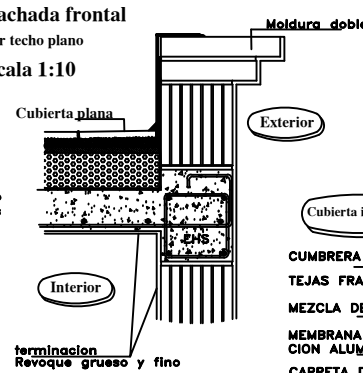

Alero de Ingreso

Escala 1:10

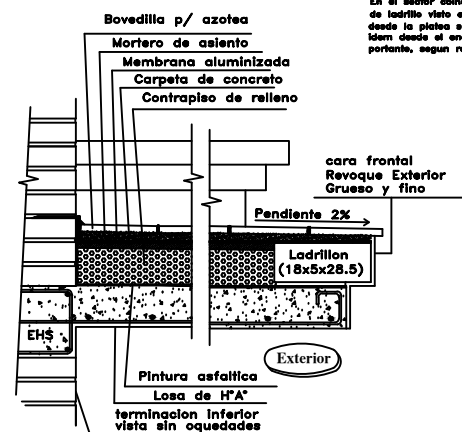

MURO RECUBRIMIENTO DE TANQUE-ladrillo visto

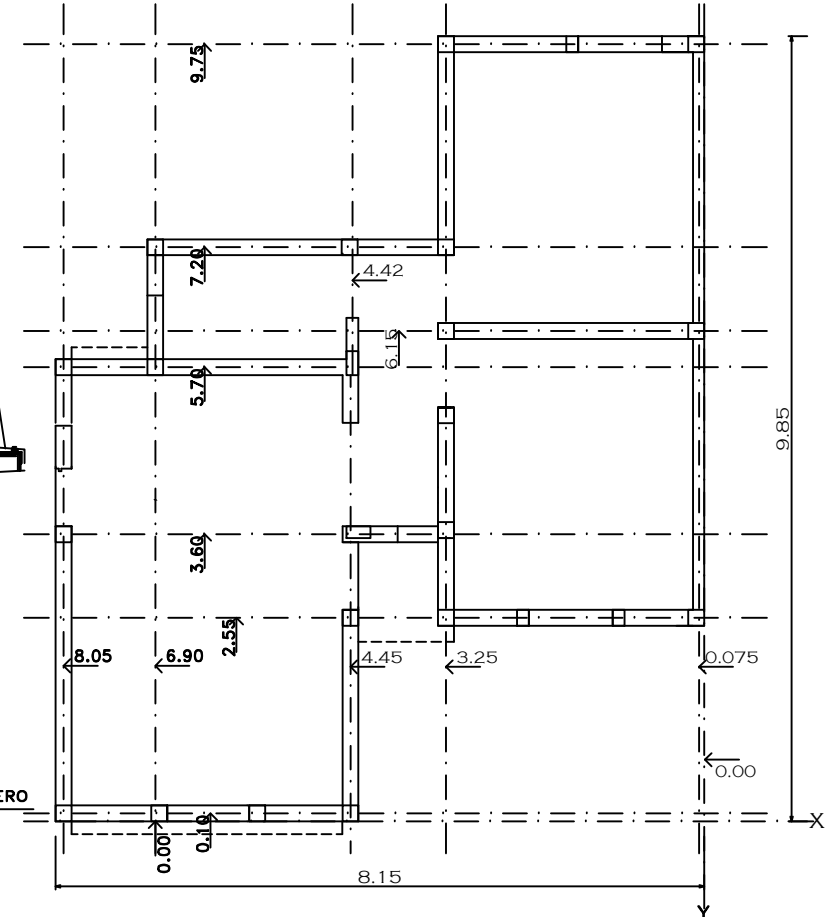
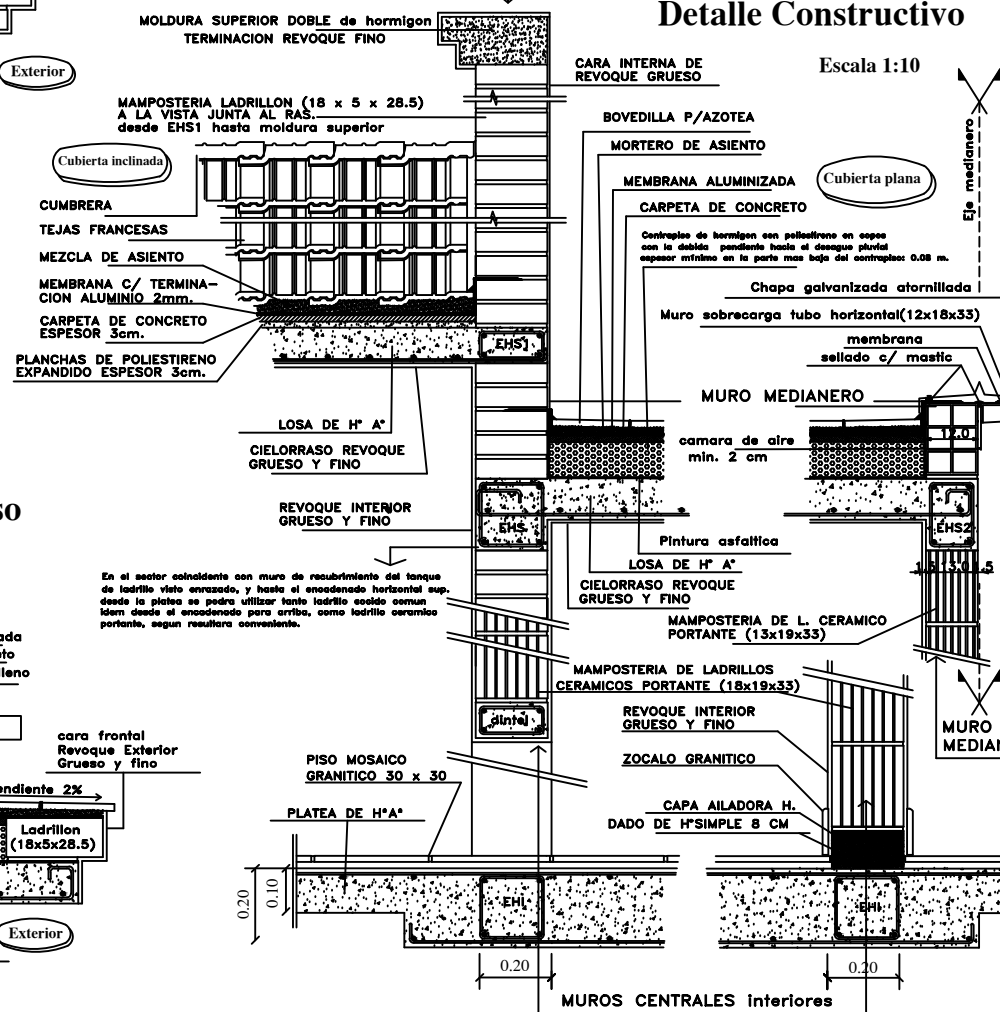

Planta de Replanteo Escala 1:50

FECHA	ESCALA	Plano de:	Plano N°
DIBUJO	PROYECTO	Detalles Constructivos Plano de Replanteo	4